

***Bucket Elevators
Classic Galvanized Series***

Standard Bucket Elevator Features:

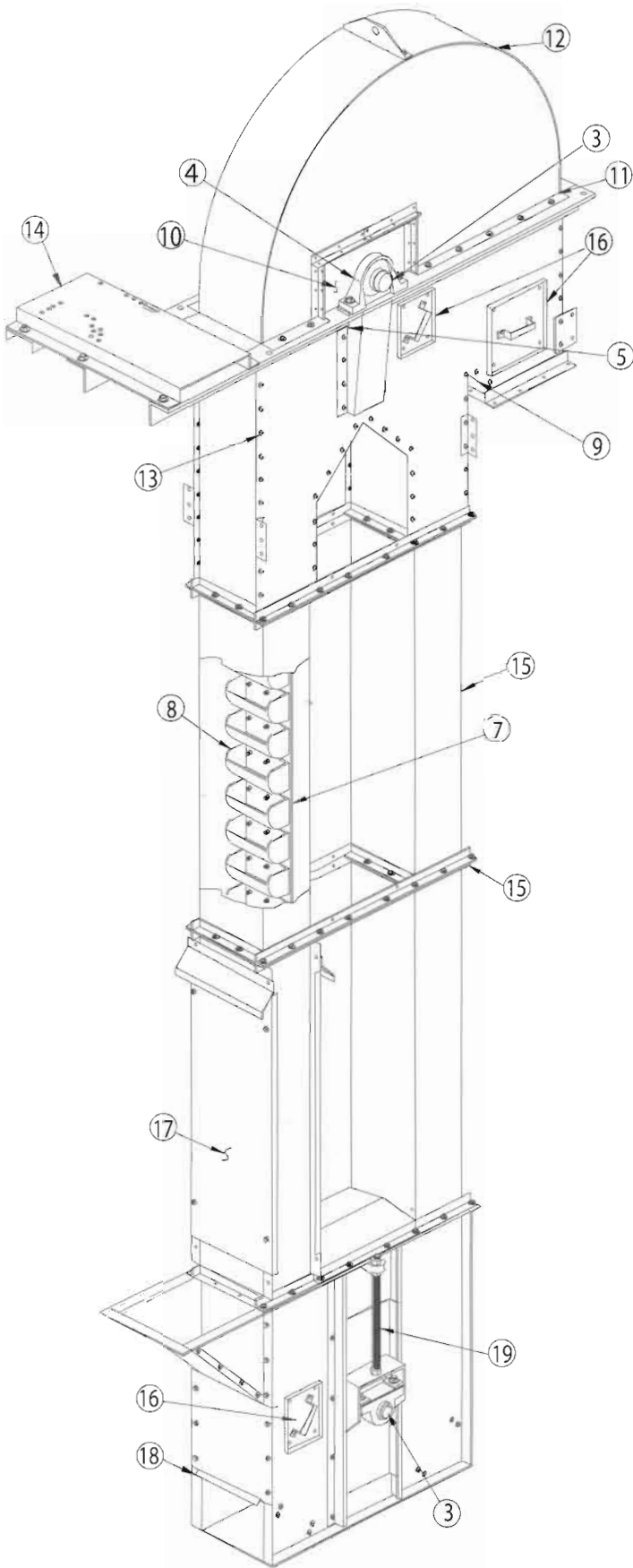

1. Galvanized steel is standard for this series of bucket elevators. Stainless steel and painted construction are available as options.
2. Nine basic series with several configurations for each series give the capacity required for every project. Custom sizes available to meet any special requirements.
3. Shafts made of #1045, turned, ground and polished steel. Shaft diameters are determined for the required load. Boot shafts are drilled and tapped for optional motion monitor.
4. Heavy-duty pillow block bearings are standard. Double roller bearings are standard for shaft sizes over 2 15/16" diameter - optional on smaller.
5. Bearing jacking bolts are standard on larger models.
6. All pulleys are crown faced for positive belt tracking and are "drum" style (except for 11" diameter which is single disc). Head pulleys have static conductive, oil and fire resistant (SOF, style 5) slide lagging. Wing style boot pulley is optional.
7. Pre-punched PVC belting is standard. Various styles of rubber belting are optional. Belting weight is determined for the required load.
8. Polyethylene buckets are standard. Metal, urethane or nylon buckets are available. Perforated buckets are available for fine or lightweight products.
9. Adjustable throat baffle for maximum discharge.
10. UHMW shaft seals are dust tight and weather resistant.
11. Head has 1/2" lip seal above head frame to keep water out and dust in.
12. Bonnets are fully contoured for efficient discharge. All bonnets have lifting lugs. Larger bonnets are split into two or three sections for easier handling.
13. Head section assembled with pin and swage locking collars to minimize welding and provide maximum corrosion protection.
14. Heavy-duty motor mount with torque arm anchorage point is standard. Gear motor, roller chain, and direct connected drives are optional.
15. Trunking is fixture welded true, square, and parallel to assure easy field fit-up. End flanges are welded continuously on both the inside and outside to prevent moisture entry and corrosion.
16. Large and conveniently placed inspection and service doors. Inspection doors at head have safety cables to prevent dropping.
17. Large 4'-0" tall removable doors on both sides of the "up" casing (with weather shield) allows easy installation and maintenance of belt and buckets.
18. Dual clean-out slides.
19. Screw take-up standard on smaller bucket elevators and optional on larger ones. Gravity take-up standard on larger bucket elevators and optional on smaller ones.
20. See individual specification sheets and quotations for additional details and special features.

Capacity Chart

Series	Maximum Capacity	
	Bushels per Hour	Cubic Feet per Hour
Mercury	1,350	1,688
Pluto	2,650	3,312
Mars	3,000	3,750
Venus	3,500	4,375
Neptune	4,750	5,938
Saturn	8,500	10,625
Jupiter	15,575	19,475
Galaxy S	16,575	20,740
Galaxy SX	20,600	25,745

Capacity based on water level plus 10% cup fill for No. 2 yellow corn at 15% moisture and with a single row of standard CC style cups spaced at normal cup projection plus 2". Other free flowing materials will have similar capacities. Sticky, very fine, or lightweight materials require special designs. Larger capacities can be achieved by using two or more rows of cups.



Additional Bucket Elevator Options:

1. Motion monitors.
2. Belt misalignment detection systems.
3. Bearing temperature monitors.
4. Atmospheric vents.
5. Head explosion relief vents.
6. Trunking explosion relief vents.
7. Low speed continuous style buckets - chain or belt mounted.
8. Ceramic chip urethane and other lining materials.
9. Guy cable mounting brackets.
10. Ladder and safety cages.
11. Service platforms – special platforms available for multiple elevator installations.
12. Boot hoppers with magnets.
13. Boot clean-out pans.
14. Self-cleaning gravity boots.
15. Frames for attachment of dust collection equipment.

Riley Equipment Manufactures A Complete Line of Bulk Material Handling Equipment . . .

■ Bucket Elevators ■ Distributors ■ Screw Conveyors ■
■ Incline Drag Conveyors ■ Super Incline Drag Conveyors ■
■ Easy-Flo Drag Conveyors ■ Sur-Flo Drag Conveyors ■ Spouting &
Accessories ■ Centrifugal & Continuous Industrial Bucket Elevators ■
For equipment designed to your specifications contact our Engineering Department.

Riley Equipment, Inc.

Phone: 812-886-5500
Fax: 812-886-5515

P.O.Box 435
2205 S. Old Decker Road
Vincennes, Indiana 47591-0435

Website: www.rileyequipment.com
E-Mail: sales@rileyequipment.com

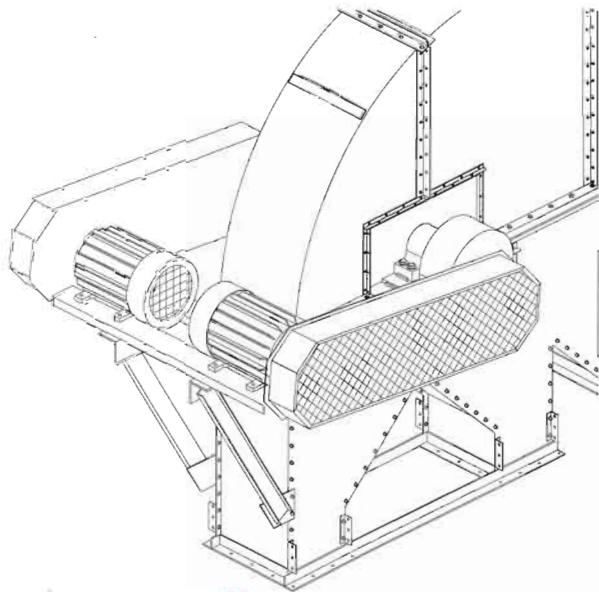

■ Dual Drives

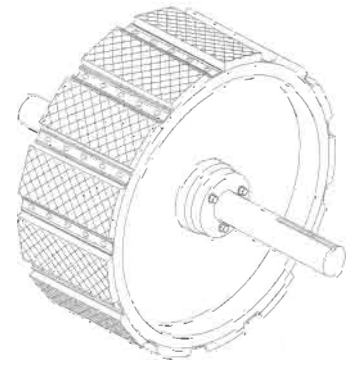

■ Drum Head Pulley with Slide Lagging Standard

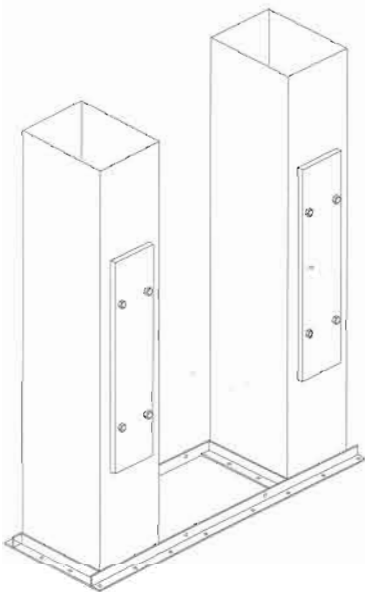

■ Explosion Relief Panels



Riley Equipment, Inc.
 P.O. Box 435
 2205 S. Old Decker Road
 Vincennes, Indiana 47591-0435

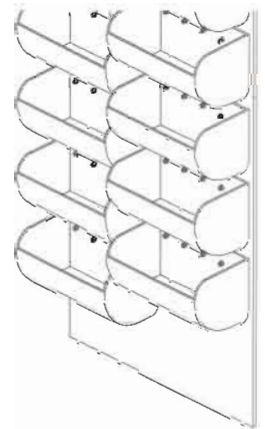

■ Staggered double row of buckets on larger models.

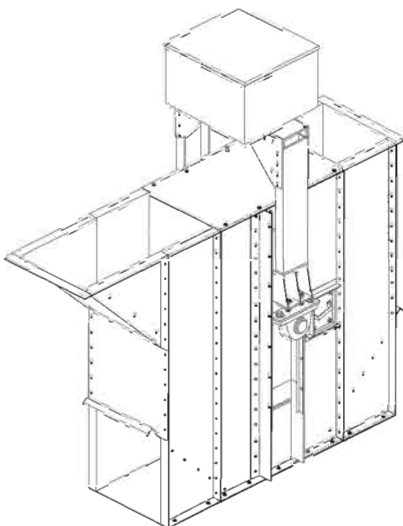

■ Gravity Take-up Boot

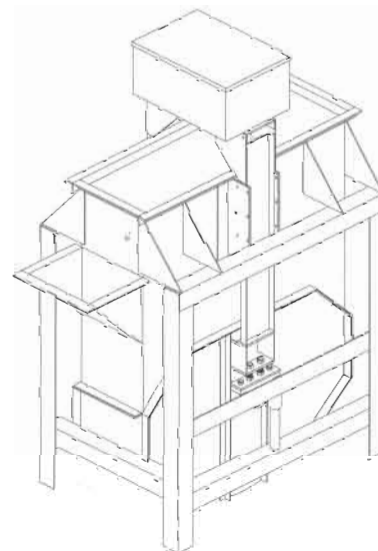

■ Self Cleaning Gravity Take-up Boot

NOTE: Exact details of some options vary with the size and style of the elevator.